

NOTES: UNLESS OTHERWISE SPECIFIED:

© COPYRIGHT 2014 TEXAS INSTRUMENTS
UNPUBLISHED, ALL RIGHTS RESERVED

REVISIONS			
REV	DESCRIPTION	DATE	BY
---	INITIAL RELEASE	09-11-2014	SS
A	ADDED THERMAL PADS, M1.7 SCREWS, UPDATED M3 WASHER	10-28-2014	SS

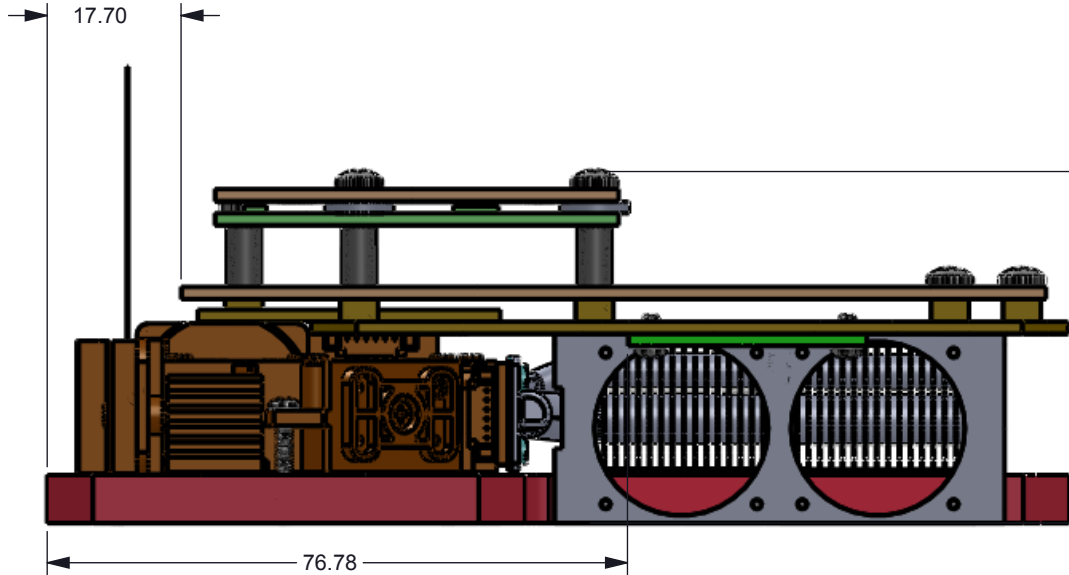
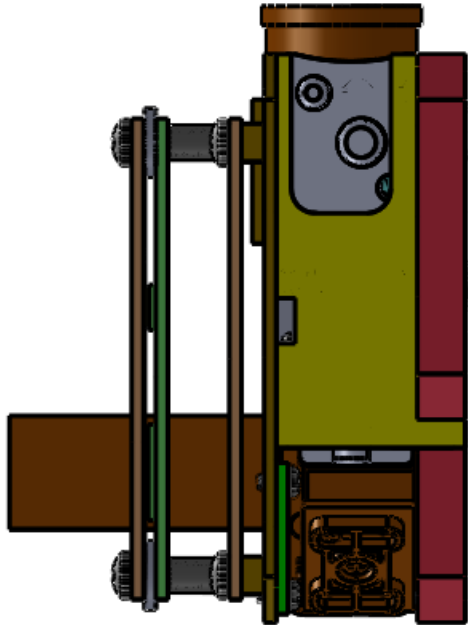
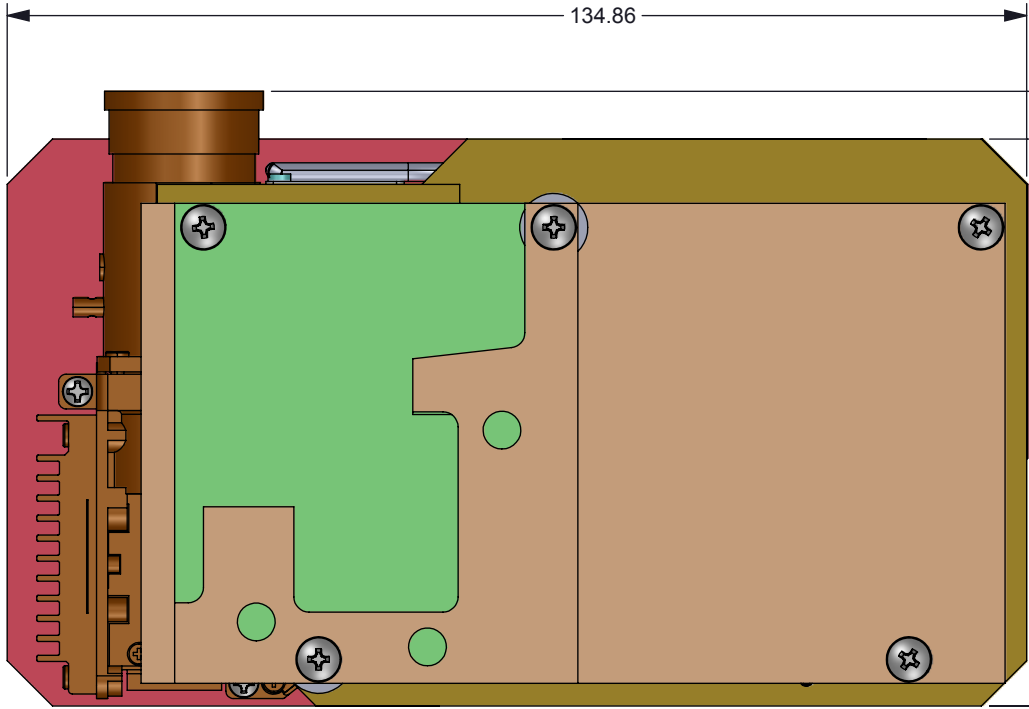

UNLESS OTHERWISE SPECIFIED

- DIMENSIONS ARE IN MILLIMETERS
- TOLERANCES: ANGLES $\pm 1^\circ$
2 PLACE DECIMALS ± 0.25
1 PLACE DECIMALS ± 0.50
- DIMENSIONAL LIMITS APPLY BEFORE PROCESSES
- INTERPRET DIMENSIONS IN ACCORDANCE WITH ASME Y14.5M-1994
- REMOVE ALL BURRS AND SHARP EDGES
- PARENTHETICAL INFO FOR REF ONLY

DWN	STEVE SMITH	DATE	8/19/2014
Engr	STEVE SMITH	DATE	8/19/2014
CQE/QA			
CM			
Apprvd			



DLP LIGHTCRAFTER 3010 EVM

SIZE	DWG NO	REV
B	3010-EVM-TOP-ASSEMBLY	A
SCALE 1:2		SHEET 1 OF 2

D

C

B

A

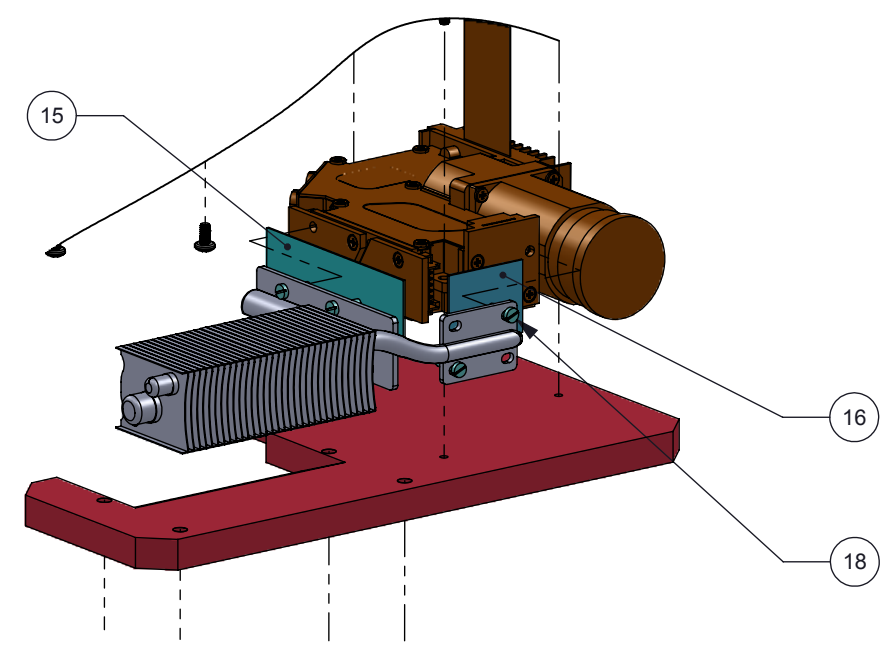
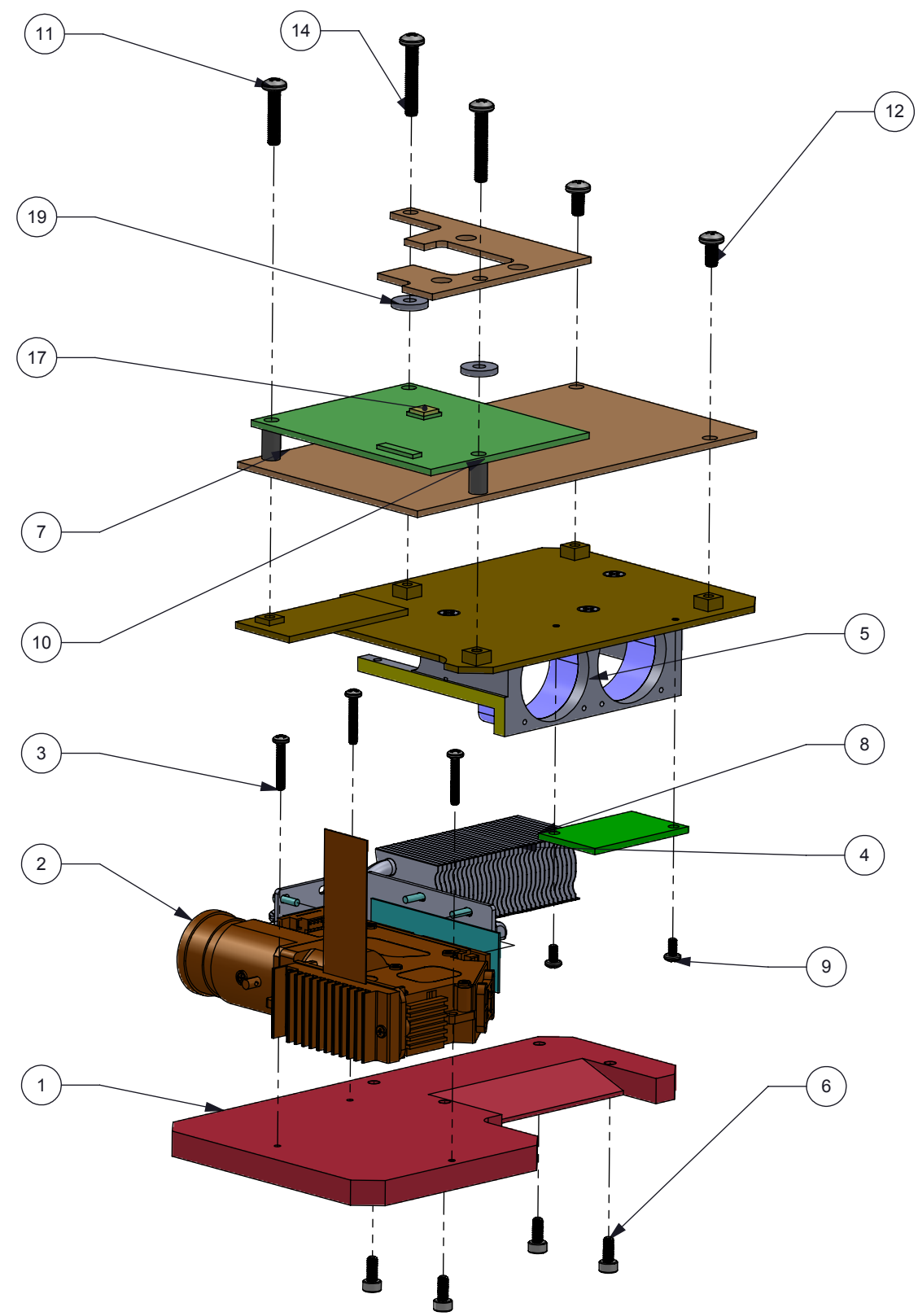

ITEM NO.	PART NUMBER	DESCRIPTION	QTY.
1	3010-EVM-ENGINE-BASE-SANDWICH	ENGINE BASE	1
2	900-0021-00 H6	ePROTECH PT3 720P DISPLAY ENGINE	1
3	90116A022	M2 X 12MM LONG PAN HEAD SCREW (McMaster-Carr)	3
4	P5_32FIN_ASM	ePROTECH PT3 720P DISPLAY ENGINE HEATSINK	1
5	3010-EVM-HEATSINK-PCB-MOUNT	HEATSINK AND PCB MOUNT ASSEMBLY	1
6	92290A056	M2.5 X 6MM LONG SHCS (McMaster-Carr)	4
7	3010-EVM-FORMATTER-DAUGHTER-CARD-ASM	FORMATTER PCB ASSEMBLY	1
8	3010-EVM-LED-CABLE-COUPLER	CABLE COUPLER	1
9	90116A008	M2 x 0.4 mm Screw With Internal Tooth-Lock Washer	2
10	94669A103	4.5 X 8MM LONG SPACER (McMaster-Carr)	3
11	90116A160	M3 X 14MM LONG PAN HEAD SCREW (McMaster-Carr)	1
12	90116A151	M3 x 0.5 mm - Screw With Internal Tooth-Lock Washer	2
13	3010-EVM-DAUGHTER-CARD-CLAMP-ASSEMBLY	CARD CLAMP	1
14	90116A163	M3 X 18MM LONG PAN HEAD SCREW (McMaster-Carr)	2
15	3010-EVM-RG-THERMAL-PAD	RED GREEN THERMAL PAD	1
16	3010-EVM-B-THERMAL-PAD	BLUE THERMAL PAD	1
17	3010-EVM-PAD2005-THERMAL-PAD	PAD2005 THERMAL PAD	1
18	SFE-M1.7-6-A2	M1.7 X 6MM CHEESE HEAD SCREW (Accuscrews)	6
19	032030011407-ND	WASHER, FLAT, M3 PLASTIC (Digi-Key)	2